

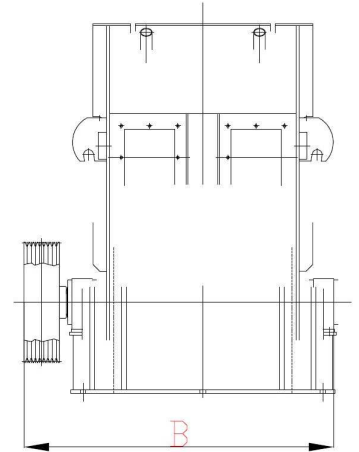

MMS MULINO SECONDARIO AD URTO SECONDARY IMPACT CRUSHER BROYEUR SECONDAIRE A PERCUSSION

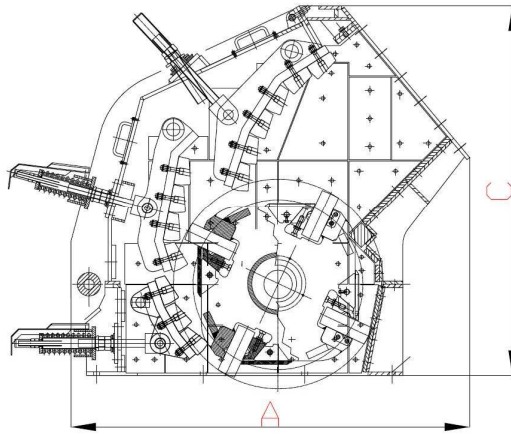

Modello Model Modèle	Peso Weight Poids (Kg)	Dimensioni Dimensions Dimensions (mm) A x B x C	Dimensioni rotore Rotor dimensions Dimensions rotor (Ø x L mm)	Dimensioni apertura Feed opening Dimension ouverture (mm)	Pezzatura max alim. Max feeding Size Pièce max alim. (mm)	Produzione Output Production (t/h)	Potenza Power Puissance (Kw)
MMS-080-050	9500	1995 x 1670 x 1950	1000 x 800	800 x 500	300	60-100	75 -132
MMS-100-050	12200	2400 x 2250 x 2660	1000 x 1000	1000 x 500	300	80-160	90 -160
MMS-110-050	13500	2780 x 2478 x 2855	1250 x 1000	1100 x 500	350	130-250	132 - 200
MMS-160-060	20500	3096 x 3273 x 2667	1300 x 1500	1500 x 600	350	160-300	160 - 315
MMS-160-080	29500	3550 x 2835 x 3270	1500 x 1500	1500 x 800	400	300-400	315 - 400
MMS-200-080	39000	3550 x 3335 x 3270	1600 x 2000	2000 x 800	450	350-480	2 x 250

PRODUCT CURVES OF SECONDARY IMPACT CRUSHERS mod. "MMS"

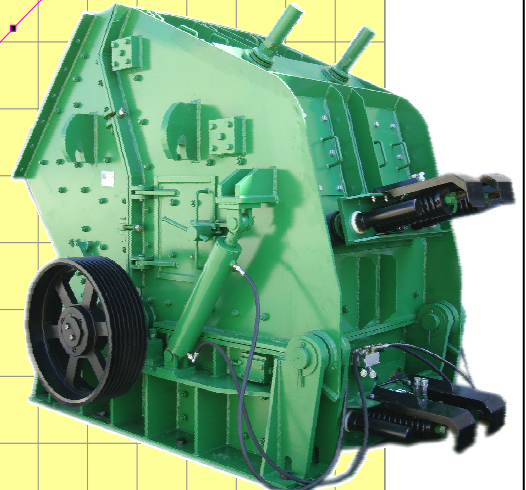
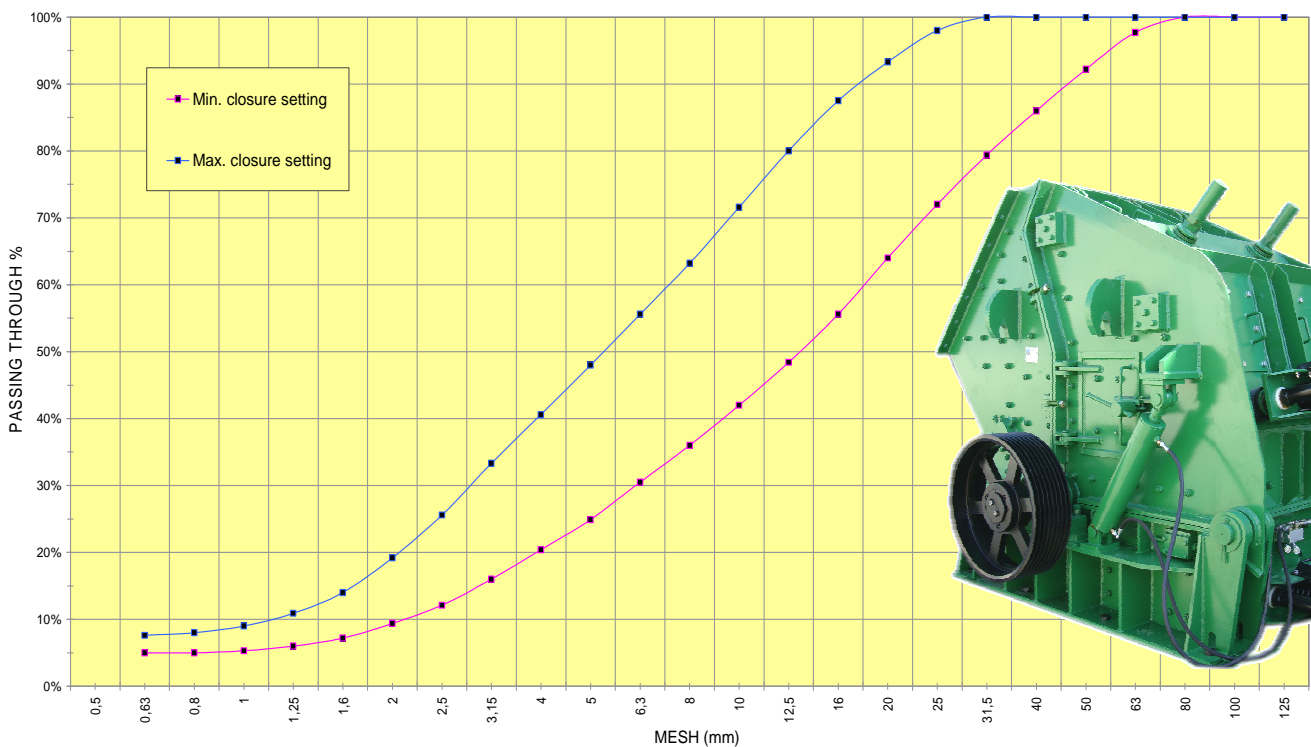

I DATI SOPRA RIPORTATI NON SONO IMPEGNATIVI E POSSONO SUBIRE VARIAZIONI SENZA PRAEAVVISO. THE ABOVE DATA ARE NOT BINDING AND THEY CAN BE ALTERED WITHOUT NOTICE.
LES DONNÉES SUS-INDIQUÉES NE COMPORTENT AUCUN ENGAGEMENT ET PEUVENT ÊTRE CHANGÉES SANS PRÉAVIS.